

ANNEXURE B

MULTIWALL

SPECIFICATION

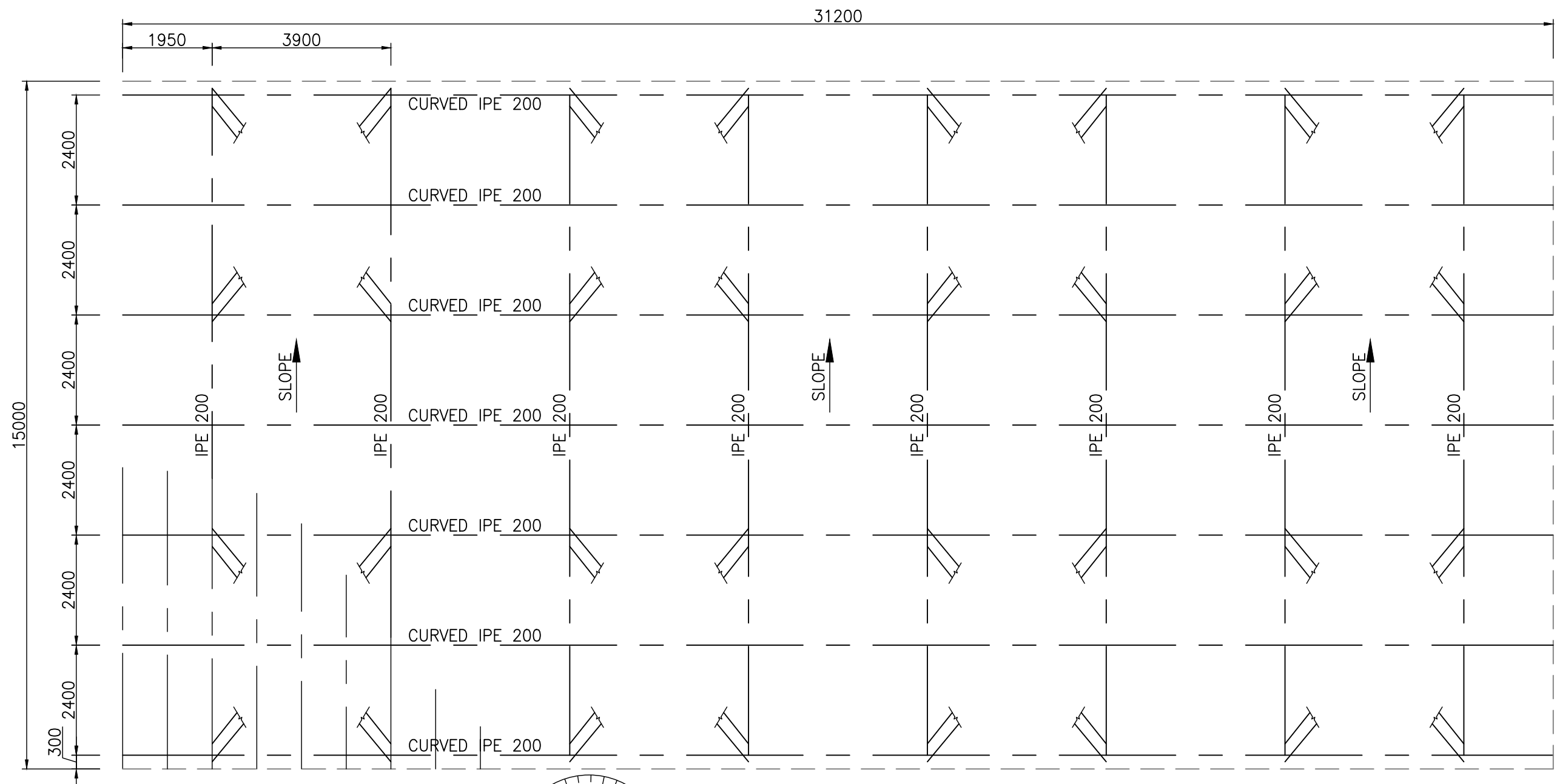

975 | 975 | 975 | 975 | 975 | 975 | 975 | 975 |
IPE 100AA PURLINS @ 975c/c

ROOF PLAN

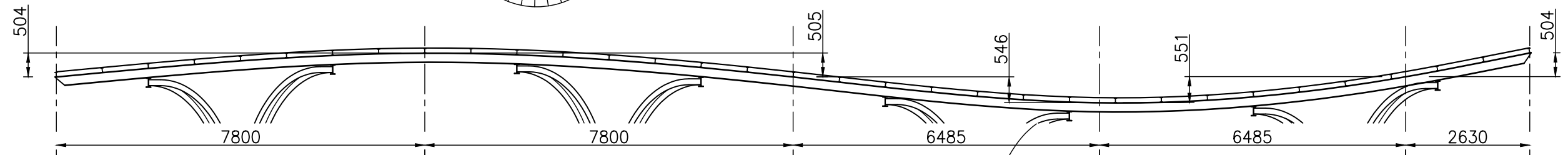
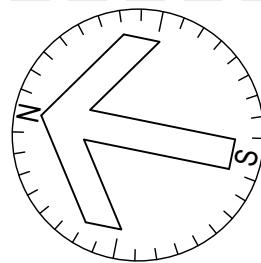

DAVID ELSTON & Associates

ENGINEERS

PROJECT MANAGERS

tel:(021) 683-0125

fax:(021) 683-5428

info@dea.co.za

Ownership and copyright of this drawing is reserved by David Elston & Associates.

CAPE ARCHEOLOGICAL SERVICES
FRANSCHHOEK SKUIFRAAM RUIN 1

STRUCTURAL LAYOUTS
ROOF STRUCTURE

REVISION

DESTROY
EARLIER
ISSUES

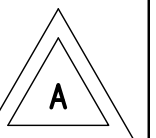

DESIGNED

CHECKED

DATE

SCALE
1:100

DRAWN
WBL

PROJECT
CAS1-02

DRAWING NO.
AP-101

Multiwall Installation Instructions

Safety Recommendations

- Never walk on or apply your weight directly to sheeting. Use walking boards along rafters at all times.
- Always exercise extreme care when walking on a roof & consider all safety requirements when working at heights.
- For safety precautions we recommend the use of safety mesh for installations above 3m.
- Use personal protective equipment such as safety footwear, safety glasses & gloves.
- We do not recommend the collection of drinking water from any roof without appropriate precautions & filtration (check with your local water authority for further advice).
- All installations & safety practices must comply with the applicable building &/or work cover codes.

Table 1.

Rafter Nominal Spacing (mm)

Sheet Thickness	Sheet Width	Rafter Spacing
10mm	700mm	720mm
10mm	1050mm	1070mm

For installation in high wind areas please contact your local Mulford Building Products office.

- 1** Install sheets with the ribs (flutes) running vertically in the direction of the fall on the roof with a minimum pitch of 5 degrees. Having sufficient fall allows natural weather action to assist in keeping the sheets clean and minimises leaking.

- 2** Check recommendation for rafter spacing in Table 1.

- 3** Multiwall sheets can be cut using a sharp knife, hand saw or circular saw with a fine tooth blade suitable for plastics. Sawdust (swarf) should be cleared from the channels with compressed air (or vacuumed) and edges should be free of notches.

If the width of the Multiwall sheets needs to be reduced, trim them as close as possible to the last rib so that optimum clamping action of the glazing bar is ensured.

- 4** Peel some of the masking back from the ends of the sheet and apply Breather Tape to the top and Sealing Tape to the bottom ends.

- 5** Place the first measured and cut Edge Bar down squarely on the structure (screw side up).

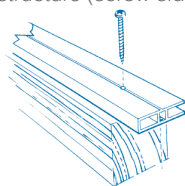

One Piece H-Bar System

Place the first measured and cut H-Bar down squarely on the structure (screw side up).

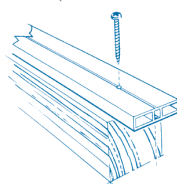

Two Piece H-bar System

Place the first measured and cut base glazing bar on the structure.

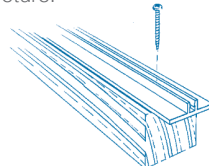

The maximum end overhang is 50mm.

- 6 One Piece H-Bar System**
Secure the H-Bar to the rafter with a screw (gauge not exceeding 12g) at no greater than 1200mm apart.

Two Piece H-bar System

Fasten the Base Glazing Bars to the rafter with Ripple Tek screws (10 gauge – 16 tpi) at no greater than 500mm apart by fixing through the center of the base glazing bar and securing it firmly onto the supporting structure. (Ripple Tek for Wood are 30mm long; Ripple Tek for Metal are 21mm in length)

- 7** Pull the masking back on the sides of the sheet and place the H-Bar gasket along the whole length of both sides of the sheet.

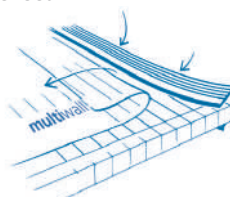

- 8 One Piece H-Bar System**
Place the next H-Bar on the other side and secure it to the support structure.

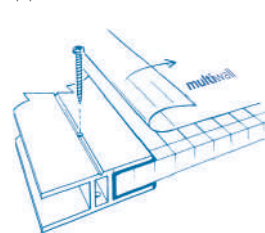

Two Piece H-bar System

Place the sheet between the secured glazing bars. Position the first top glazing bar in line with the base. Secure the two bars using a rubber mallet.

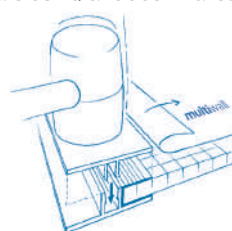

It is recommended that the top glazing bar is secured to the rafter with screws (gauge not exceeding 12g) at no greater than 1200mm apart. Once the next sheet is installed the second and subsequent top glazing bars can be fitted.

- 9** Repeat steps 6-8 until all sheets are in position.

- 10** When using Aluminium End Caps, place the end gasket along the end of the Multiwall sheet only, stopping at the H-Bar.

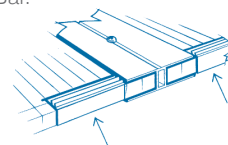

- 11** Fasten the Aluminium End Cap with a screw to the H-Bar. On the underneath of the Aluminium End Cap drill a small weep hole where it meets the H-Bar.

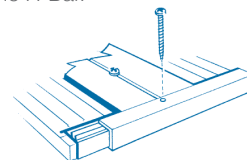

- 12** Use the Edge Bar to finish the assembly on the final rafter.

IMPORTANT

Sealants - These instructions are designed to prevent leaking and alleviate the requirement for sealants. Sealants, especially silicone, are incompatible with polycarbonate. They will damage the sheet, restrict expansion and contraction, and void the warranty. Use the appropriate Multiwall accessories to complete your project and help protect your structure, without the need for sealants.

Thermal Expansion - When inserting sheet into glazing sections allowance must be made for expansion.

* Full Warranty terms & conditions are available from www.laserlite.com.au or via a Mulford Building Products office. It is the responsibility of the purchaser to obtain a copy of the full Warranty terms & conditions. All lightweight Multiwall sheets are manufactured from high-tech, high quality Makrolon® polycarbonate resin for high impact resistance, excellent transparency, UV stability & excellent fire resistance.

New South Wales

T 02 9677 9900
F 02 9677 9500
E nswmbp@mulford.com.au

Newcastle

T 02 4940 8922
F 02 4940 8362
E ordersnewcastle@mulford.com.au

Queensland

T 07 3717 4700
F 07 3717 4777
E qldmbp@mulford.com.au

Victoria

T 03 8791 8000
F 03 8791 8088
E vicmbp@mulford.com.au

Tasmania

T 03 6288 6000
F 03 6288 6010
E tasmmbp@mulford.com.au

South Australia

T 08 8444 9666
F 08 8444 9600
E sambp@mulford.com.au

Western Australia

T 08 9240 6655
F 08 9240 8877
E wambp@mulford.com.au



MULFORD
BUILDING PRODUCTS
delivering solutions

Mulford Building Products

T +61 2 9911 8109
F +61 2 9911 8101
Unit 22, Slough Business Park,
Holker Street, Silverwater NSW 2128 Australia
ABN 86 000 057 170

ANNEXURE C

SKUIFRAAM 1 AND 2

NO-GO AREA AND

LAYDOWN AREA



Skuifraam 1 to the right & Skuifraam 2 to the left looking down from the dam wall

ANNEXURE D

BERG WATER PROJECT ENVIRONMENTAL MANAGEMENT PLAN APPROVAL

BS/103/2

09/10/2003 09:04 27123103688

DEAT

PAGE 01



**DEPARTMENT OF ENVIRONMENTAL AFFAIRS AND TOURISM
REPUBLIC OF SOUTH AFRICA**

**TEL: (012) 310-3911
FAX: (012) 322 2689**

FAX COVER SHEET

DATE:

9/10/03

TO:	Mr BHJ Smit		
ORGANISATION:	TCTA		
FAX:	(012) 663 5054		
FROM:	Danie Smit		
TEL:	(012) 310-3659	ROOM NO:	
FAX:	(012) 310-3688		
E-MAIL:	dsmit@ozone.pwv.gov.za		
NO PAGES:	2		
SUBJECT:	Approval: Environmental Management Plan: Berg Water Project		
MESSAGE:	<p>Mr Smit</p> <p>Please find attached for your information.</p> <p>Regards</p> <p>Danie Smit</p>		



**DEPARTMENT: ENVIRONMENTAL AFFAIRS AND TOURISM
REPUBLIC OF SOUTH AFRICA**

Private Bag X447, Pretoria, 0001 Tel: (27-12) 310 3911, Fax: (27-12) 322 2882
Fedeure Forum Building, North Tower, cor Van der Walt and Pretorius Streets, Pretoria
www.environment.gov.za

Ref: A24/16/3/142

Enquiries: DWJ Smit

Tel: (012) 310 3659 Fax: (012) 310 3688 e-mail: dsmit@ozone.dmw.gov.za

Mr W S Croucamp
Department of Water Affairs and Forestry
Private Bag X 313
PRETORIA
0001

Fax: (012) 326 2630

Dear Mr Croucamp

APPROVAL: ENVIRONMENTAL MANAGEMENT PLAN: BERG WATER PROJECT

I refer to your letter dated 3 August 2003 with regard to the above-mentioned issue.

This department and the Western Cape Department of Environmental Affairs and Development Planning have evaluated the environmental management plan (EMP) dated July 2003 that was submitted to this department for acceptance. The department have decided to approve the EMP for the Berg Water Project subject to the following conditions:

- That the EMP may be altered, where independent monitoring and auditing of the project show this to be beneficial. Any alterations to the final EMP shall be subject to approval by the relevant authorities.
- That all information and plans regarding the EMP be shared with the EMC and that their questions be addressed on request.

Yours sincerely

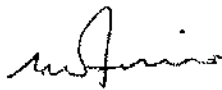
m DIRECTOR-GENERAL
DATE: 2003/10/03.

CC: Mr J Chihota ARUP
Mr BHJ Smit TCTA
Mr Z Toefy DEADP

(021) 421 6502
(012) 663 5054
(021) 483 3472

ANNEXURE E

HERITAGE WESTERN CAPE PERMIT FOR SKUIFRAAM

Our Ref: HM/CAPE WINDLANDS/STELLNBOSCH/ FRANSCHHOEK/ERVEN 11149 AND 1629
Case No.: 18021318AS0215M
Enquiries: Stephanie-Anne Barnardt
E-mail: stephanie.barnardt@westerncape.gov.za
Tel: 021 483 5959
Date: 18 February 2021



Mary Patrick
mary@casprojects.co.za

PERMIT

CASE #: 18021318AS0215M

Issued in terms of Section 35(4) of the National Heritage Resources Act, 1999 (Act 25 of 1999) and Regulation 3(3)(a) of PN 298 (29 August 2003)

This permit is valid for three years from the date of issue

Your application for the proposed ruins rehabilitation and stabilisation of part of the Skuifraam Archaeological Interpretation Site, Farm Skuifraam 11149 and 1629, Berg River Dam, Franschhoek was tabled at the Archaeology, Palaeontology and Meteorites meeting held on 3 February 2021.

DECISION

The committee approved the application for the permit extension to Ms Mary Patrick of Cape Archaeological Survey for a further three years.

Proposed Action: Proposed rehabilitation and stabilization as part of the Skuifraam Archaeological Interpretation Site.

Site: Farm Skuifraam 11149 and 1629, Berg River Dam, Franschhoek

Conditions applicable to this Permit:

1. Adequate recording methods as specified in the Regulations and Guidelines pertaining to the National Heritage Resources Act must be used.
 2. Adequate recording methods as specified in the Regulations and Guidelines pertaining to the National Heritage Resources Act must be used.
 3. A final report, in both digital and hardcopy format, MUST be submitted to HWC on or before **18 February 2024**. An extension to this permit can be granted on submission of a progress report (if work was initiated) and a letter stating reasons for the extension. HWC reserves the right to withhold further permits if progress is not deemed satisfactory.
 4. All material collected and excavated, as well as field notes and records, will be curated by the Iziko: South African Museum.
 5. Reprints of all published papers or copies of theses or reports resulting from this work must be lodged with HWC.
 6. If a published report has not appeared within three years of the lapsing of this permit, the report in terms of the permit will be made available to researchers on request.
 7. It is the responsibility of the permit holder to obtain permission from the landowner for each visit, and conditions of access imposed the landowner must be observed.
 8. HWC shall not be liable for any losses, damages or injuries to persons or properties as a result of any activities in connection with this permit.
 9. HWC reserves the right to cancel this permit by notice to the permit holder.
- This decision is subject to an **appeal period of 14 working days**.
 - Appeals to HWC are to be submitted to HWC.Appeals@westerncape.gov.za
 - The applicant is required to inform any party who has expressed a bona fide interest in any heritage-related aspect of this record of decision. The appeal period shall be taken from the date above. It should be noted that for an appeal to be deemed valid it must refer to the decision, it must be submitted by the due date and it must set out the grounds of the appeal. Appeals must be addressed to the official named above and it is the responsibility of the appellant to confirm that the appeal has been received within the appeal period.
 - **Work may NOT be initiated during this 14 day appeal period.**
 - This approval does not exonerate the applicant from obtaining any necessary approval from any other applicable statutory authority.
 - an export permit must be applied for from SAHRA in respect of any archaeological or palaeontological material that will be exported.
 - **A copy of this permit must be displayed in a prominent place on the site until the permitted work is completed**

.....
Colette M Scheermeyer
Acting Chief Executive Officer

www.westerncape.gov.za/cas



Street Address: Protea Assurance Building, Green Market Square, Cape Town, 8000 • **Postal Address:** P.O. Box 1665, Cape Town, 8000
• **Tel:** +27 (0)21 483 5959 • **E-mail:** ceoheritage@westerncape.gov.za

Straatadres: Protea Assuransie-gebou, Groentemarkplein, Kaapstad, 8000 • **Posadres:** Posbus 1665, Kaapstad, 8000
• **Tel:** +27 (0)21 483 5959 • **E-pos:** ceoheritage@westerncape.gov.za

Idilesi yendawo: kumgangatho 3, kwisakhiwo iprotea Assurance, Greenmarket Square, eKapa, 8000 • **Idilesi yeposi:** Inombolo yebhokisi yeposi 1665, eKapa, 8000 • **Inombolo zomnxeba:** +27 (0)21 483 5959 • **Idilesi ye-imeyile:** ceoheritage@westerncape.gov.za